

PLUM TREE

APARTMENT HOMES

1097 Maywood Lane
Martinez, CA 94553
tel: 925.370.0300 | fax: 925.370.7177
www.ExperiencePlumTree.com

The hallmark of this delightful floorplan is the spacious master bedroom, while the dozens of designer and convenience-oriented features; such as, private laundry center, linen closet, gourmet kitchen, oversized windows and more, will surely please you.

residence 3

2 Bedrooms | 1 Bathroom | 808 sq. ft.

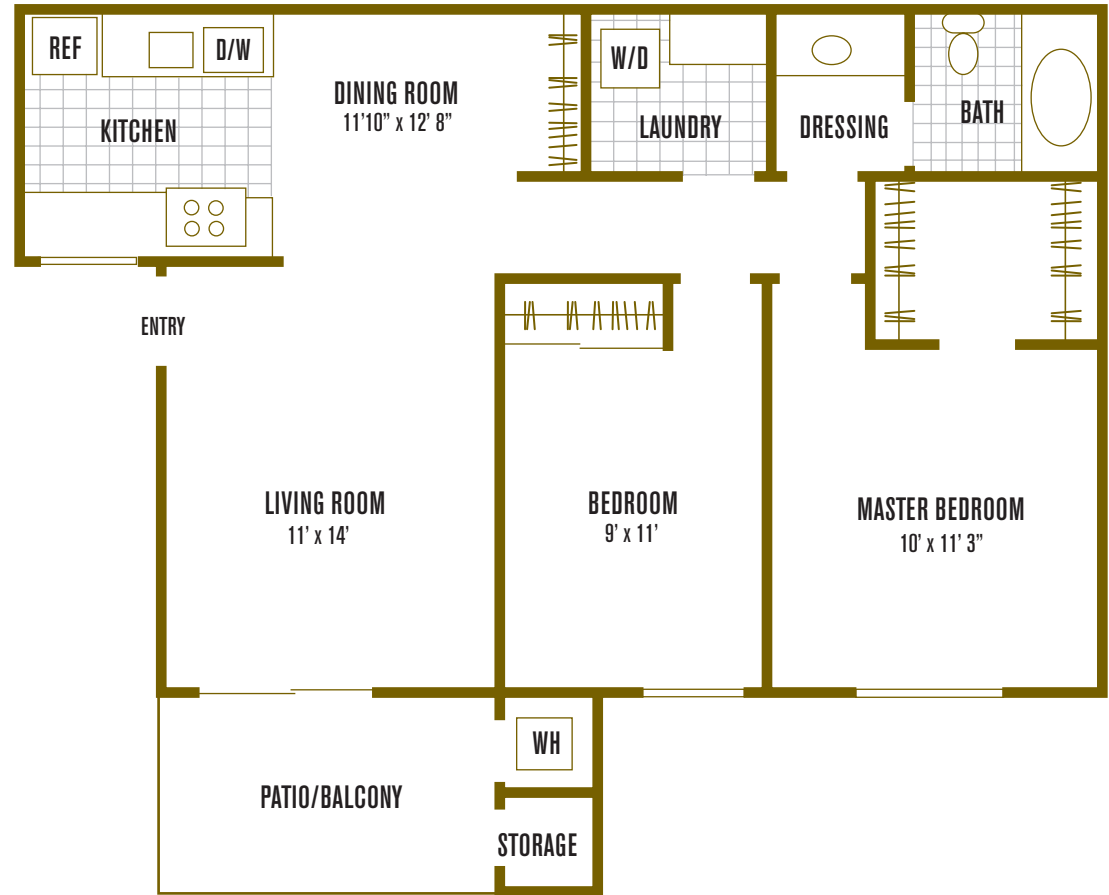

notes: _____

All room dimensions and square footages are approximate.

